

Ultra small waterproof connector L angle 2-6 cores

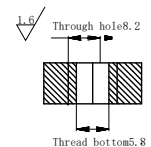

| | | | |
|---|--|--|--|
| <p>Ultra small L-shaped cable color:</p> <p>2-core: 1: red 2: black 3-core: 1: Red 2: Black 3: Brown 4-core: 1: red 2: black 3: Brown 4: Blue 5-core: 1: Orange white 2: Orange 3: Green white 4: Green 5: Blue and White 6-core: 1: Orange white 2: Orange 3: Green white 4: Green 5: Blue White 6: Blue</p> | <p>Main parameters:</p> <p>Ultra-miniature electrical 2-4 core parameters: 550V @ 2-5A Ultra-miniature electrical 5-6 core parameters: 550V @ 2A Insulation resistance: >200 MΩ contact resistance: <0.01 Ω Operating temperature: -60° ~ +80° C Working depth: 6000M(60 MPa)</p> | <p>Material parameters:</p> <p>Plug body: Neoprene Socket body: 316L stainless steel, Titanium alloy, Sea copper Cable body: Polyurethane, Neoprene Needle core: Copper gilding Installation requirements: Installation radius: 7.3 Surface finish: Ra1.6</p> | <p>Dimension units: millimeter Thread unit: inch Mounting thread: 5/16-24UNF-2A Thread length: 10mm</p> <p>Can be customized upon request</p> |
|---|--|--|--|

Ultra small waterproof connector 2-6 cores

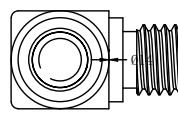
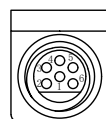
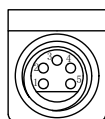
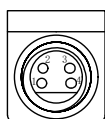
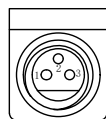
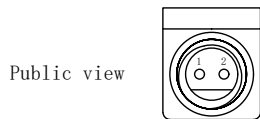
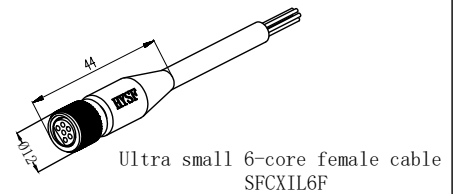
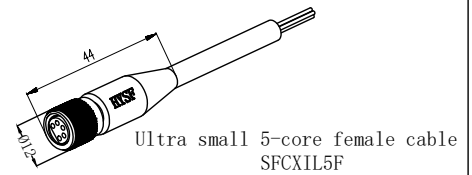
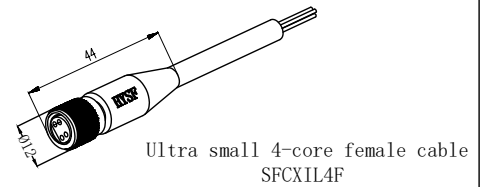
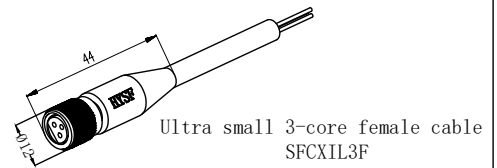
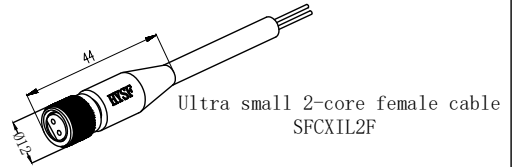
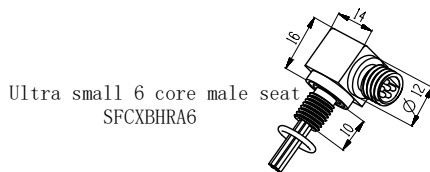
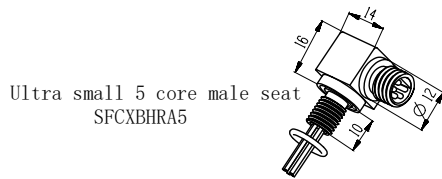
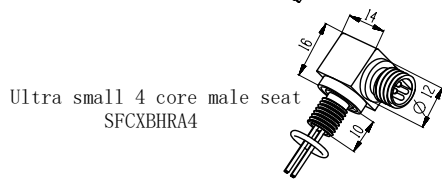
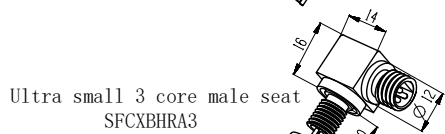
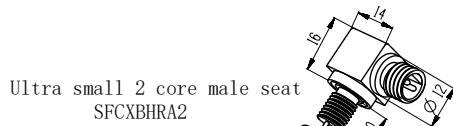

Ultra small 2 core male seat
SFCXBH2M

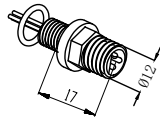

Ultra small 3 core male seat
SFCXBH3M

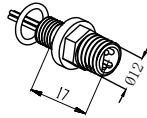

Ultra small 4 core male seat
SFCXBH4M

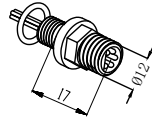

Ultra small 5 core male seat
SFCXBH5M

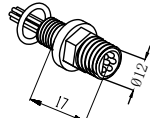

Ultra small 6 core male seat
SFCXBH6M

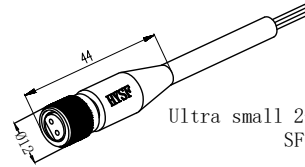

Ultra small 2-core female cable
SFCXIL2F

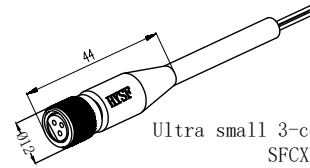

Ultra small 3-core female cable
SFCXIL3F

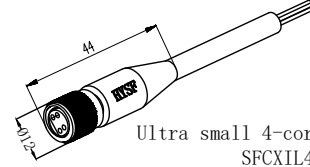

Ultra small 4-core female cable
SFCXIL4F

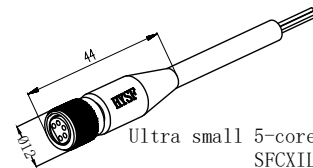

Ultra small 5-core female cable
SFCXIL5F

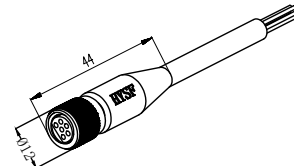

Ultra small 6-core female cable
SFCXIL6F

Public view

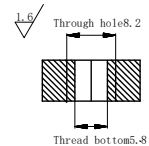
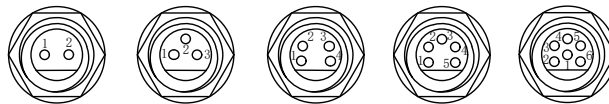

Ultra small cable color:

- 2-core: 1: red 2: black
- 3-core: 1: Red 2: Black
3: Brown
- 4-core: 1: red 2: black
3: Brown 4: Blue
- 5-core: 1: Orange white 2: Orange
3: Green white 4: Green
5: Blue and White
- 6-core: 1: Orange white 2: Orange
3: Green white 4: Green
5: Blue White 6: Blue

Main parameters:

Ultra-miniature electrical
2-4 core parameters: 550V @ 2-5A
Ultra-miniature electrical
5-6 core parameters: 550V @ 2A
Insulation resistance: >200 MΩ
contact resistance: <0.01Ω
Operating temperature: -60° ~ +80° C
Working depth: 6000M(60 MPa)

Material parameters:

Plug body: Neoprene
Socket body: 316L stainless steel,
Titanium alloy, Sea copper
Cable body: Polyurethane, Neoprene
Needle core: Copper gilding
Installation requirements:
Installation radius: 7.3
Surface finish: Ra1.6

Dimension units: millimeter

Thread unit: inch
Mounting thread: 5/16-24UNF-2A
Thread length: 10mm

Can be customized upon request

Ultra small waterproof connector 6-16 cores

Ultra small 6 core male seat
SFCXZBH6M

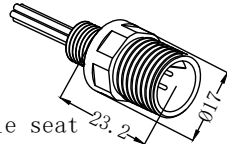

Ultra small 8 core male seat
SFCXZBH8M

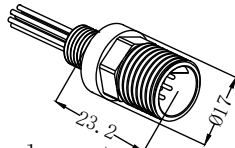

Ultra small 10 core male seat
SFCXZBH10M

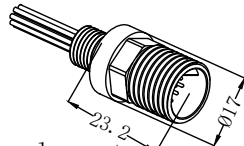

Ultra small 12 core male seat
SFCXZBH12M

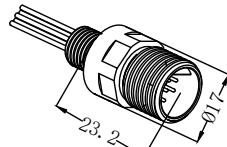

Ultra small 16 core male seat
SFCXZBH16M

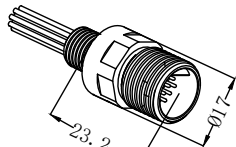

Ultra small 6-core female cable
SFCXZIL6F



Ultra small 8-core female cable
SFCXZIL8F



Ultra small 10-core female cable
SFCXZIL10F



Ultra small 12-core female cable
SFCXZIL12F

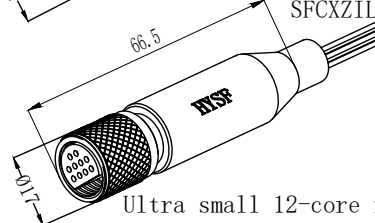

Ultra small 16-core female cable
SFCXZIL16F

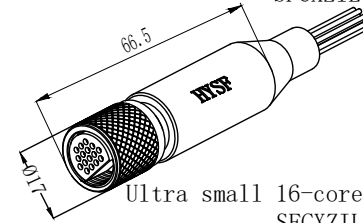

Public view

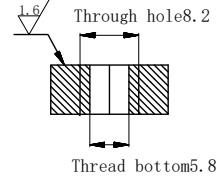
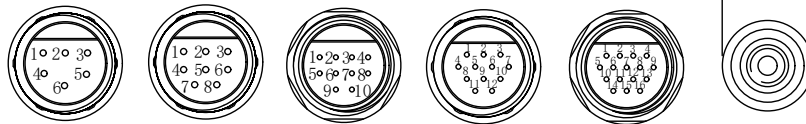

Ultra small cable color:
 6-core:1:Red 2:Black 3:Yellow
 4:Blue 5:Orange 6:Brown
 8-core:1:Red 2:Black 3:Yellow 4:Blue
 5:Orange 6:Brown 7:Purple 8:Green
 10 cores:1:Red 2:Red and White 3:Black
 4:Black and White 5:Yellow 6:Yellow White
 7:Blue 8:Blue White 9:Orange
 10:Orange White
 12 cores:1:Red 2:Red and White 3:Black
 4:Black and White 5:Yellow 6:Yellow and
 White 7:Blue 8:Blue White 9:Orange
 10:Orange White 11:Brown 12:White
 16 cores:1:Red 2:Black 3:Yellow 4:Blue
 5:Orange 6:Brown 7:Purple 8:Green 9:Orange
 White 10:Orange 11:Green White 12:Blue
 13:Blue and white 14:green
 15:brown and white 16:brown

Main parameters:

Ultra-miniature electrical
 6-8 core parameters: 550V @ 5A
 Ultra-miniature electrical
 10-12 core parameters: 550V @ 2A
 Ultra-miniature electrical
 16 core parameters:
 550V @ 8*Cat5+8*Cat6
 Insulation resistance: >200 MΩ
 contact resistance: <0.01 Ω
 Operating temperature: -60° ~ +80° C
 Working depth: 6000M (60 MPa)

Material parameters:

Plug body: Neoprene
 Socket body: 316L stainless steel,
 Titanium alloy, Sea copper
 Cable body: Polyurethane, Neoprene
 Needle core: Copper gilding
 Installation requirements:
 Installation radius: 9.3
 Surface finish: Ra1.6

Dimension units: millimeter

Thread unit: inch
 Mounting thread: 3/8-24UNF-2A
 Thread length: 10mm

Can be customized upon request

Ultra small waterproof connector 12-28 cores

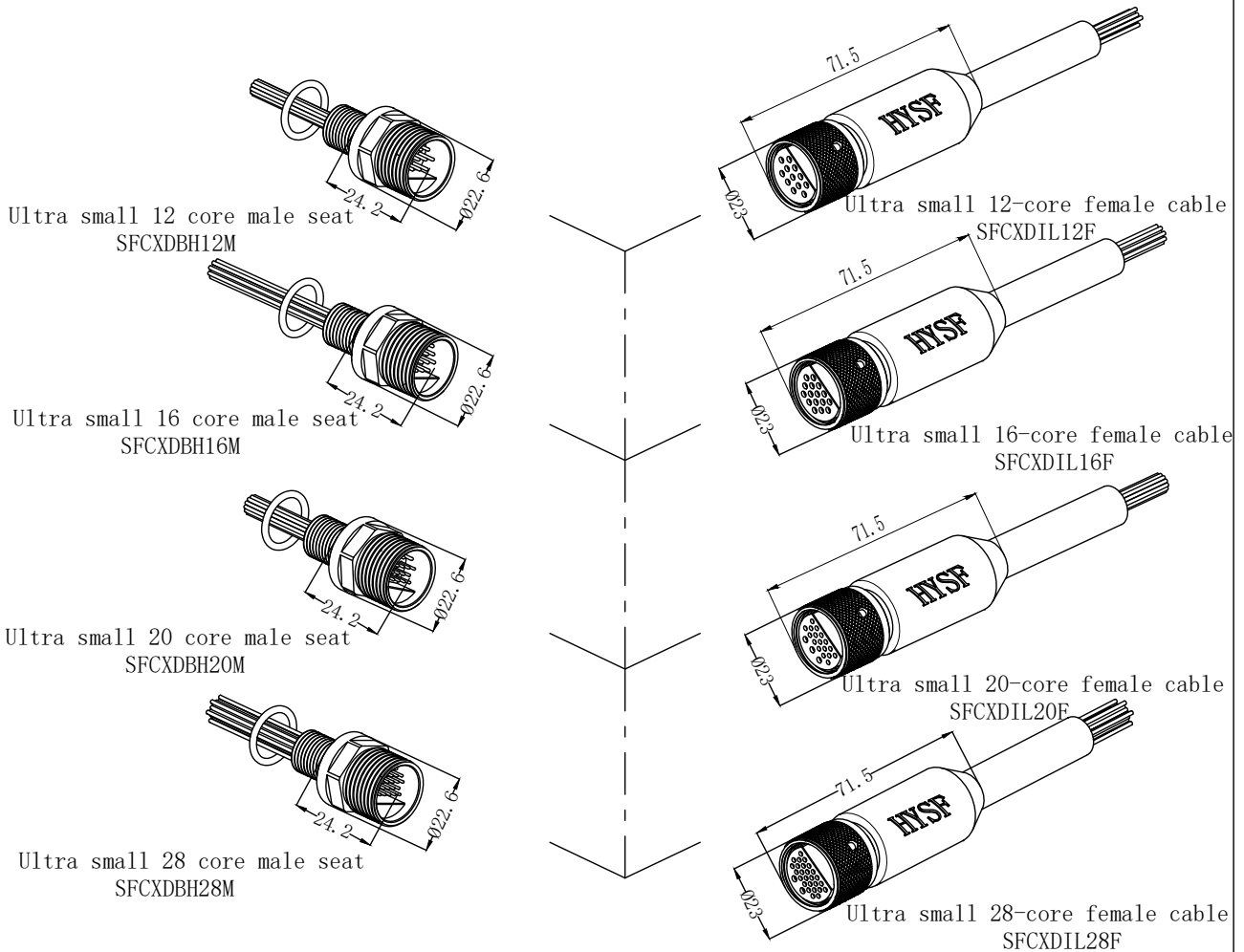

Public view

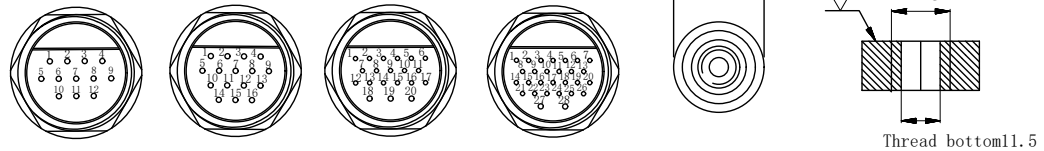

| | | | |
|---|---|--|--|
| <p>Ultra small cable color:</p> <p>12 cores: 1: Red 2: Red and White 3: Black 4: Black and White 5: Yellow 6: Yellow and White 7: Blue 8: Blue White 9: Orange 10: Orange White 11: Brown 12: White</p> <p>16 cores: 1: Red 2: Black 3: Yellow 4: Blue 5: Orange 6: Brown 7: Purple 8: Green 9: Orange White 10: Orange 11: Green White 12: Green 13: Blue and white 14: Blue 15: Brown and white 16: Brown</p> <p>20 cores: 1: Orange white 2: Orange 3: Green white 4: Green 5: Blue White 6: Blue 7: Brown White 8: Brown 9-16: Same as above 17: Red 18: Black 19: Yellow 20: Green</p> <p>28 cores: 1: Orange white 2: Orange 3: Green white 4: Green 5: Blue White 6: Blue 7: Brown White 8: Brown 9-16: Same as above 17-24: Same as above 25: Blue and White 26: Blue 27: Red 28: Black</p> | <p>Main parameters:</p> <p>Ultra-miniature electrical 12core parameters: 550V@ 5A Ultra-miniature electrical 16 core parameters: 550V@8*0.5+Ccat6 Ultra-miniature electrical 20core parameters: 550V@ 3*0.5+2*0.2+Ccat5+Ccat6 Ultra-miniature electrical 28 core parameters: 550V@ 2*0.5+2*0.2+2*Ccat5+Ccat6 Insulation resistance: >200 MΩ contact resistance: <0.01Ω Operating temperature: -60° ~+80° C Working depth: 6000M(60 MPa)</p> | <p>Material parameters:</p> <p>Plug body: Neoprene Socket body: 316L stainless steel, Titanium alloy, Sea copper Cable body: Polyurethane, Neoprene Needle core: Copper gilding Installation requirements: Installation radius: 12.3 Surface finish: Ra1.6</p> | <p>Dimension units: millimeter Thread unit: inch Mounting thread: 1/2-20UNF-2A Thread length: 10mm</p> <p>Can be customized upon request</p> |
|---|---|--|--|